



FIELD FABRICATED SHROUDS

These Shroud designs have been certified and tested for DESA fireplace systems for use with the Round Top Termination Series for 8-inch (RT/RTT/RTL/RTTL – 8DM), 10-inch (RTL-10DM) and 12-inch (RTL-12D) chimney pipe systems. These Shroud designs must be constructed from a minimum 26 ga. aluminized steel and may be field constructed if the dimensional requirements specified below are maintained.

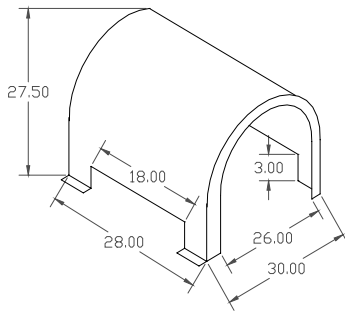

FIGURE 1 STANDARD ARCH SHROUD

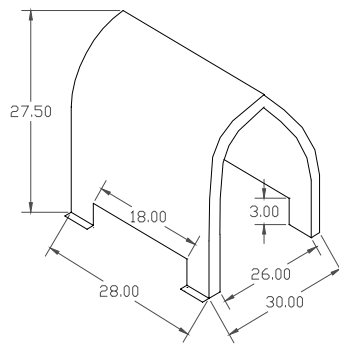

FIGURE 2 BISHOPS ARCH SHROUD

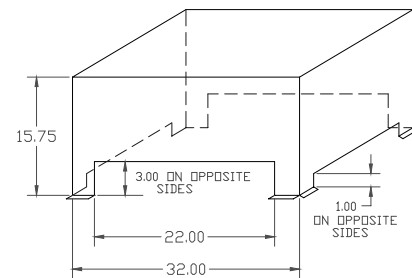

FIGURE 3 SQUARE SHROUD

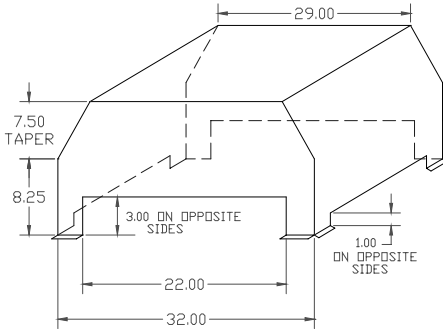

FIGURE 4 SQUARE SHROUD (TAPERED)

NOTE: ALL DIMENSIONS ARE MINIMUM

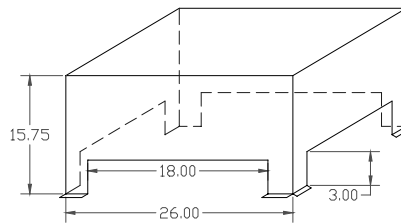

FIGURE 5 SQUARE SHROUD

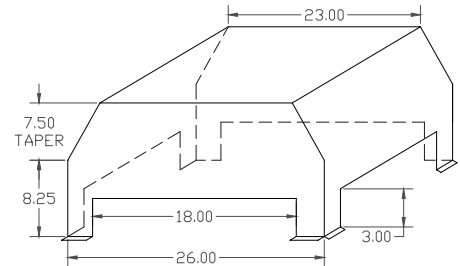

FIGURE 6 SQUARE SHROUD (TAPERED)

THE MINIMUM SPACER CLEARANCE AND THE TYPE OF TERMINATION CAP USED WILL DETERMINE WHICH SHROUD DESIGN IS APPROPRIATE. PLEASE REFER TO PAGE 3, FIGURES 10 AND 11 FOR DETAILS.

SHROUD INSTALLATION

The Round Top Termination should be installed completely (refer to the installation instructions supplied with your DESA termination) before installing the shroud. A Six-inch minimum clearance must be maintained between the bottom of the termination and the top of the flashing (see fig. 7). Place the shroud over the chase top flashing and secure with sheet metal screws (see fig. 8). **REFER TO PAGE 3 FOR MINIMUM CHASE TOP FLASHING CLEARANCE AND TERMINATION CAP MODEL.**

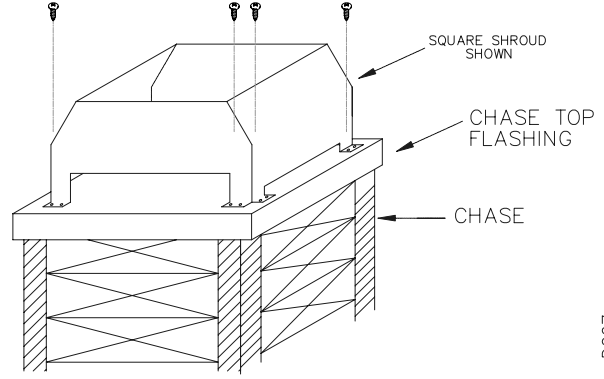
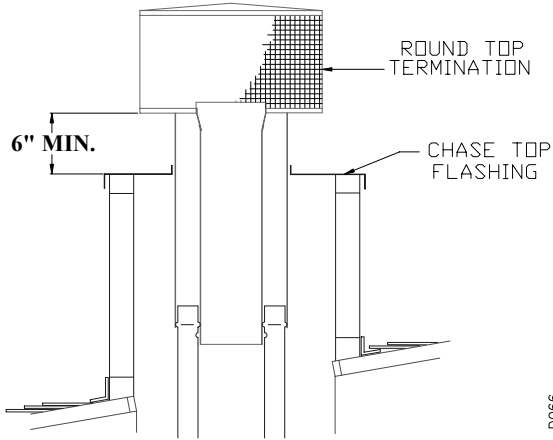

Figure 7 SIX-INCH MINIMUM CLEARANCE

Figure 8 SHROUD INSTALLATION

CONSTRUCTING THE CHASE TOP FLASHING

Fabricate a flashing with the required diameter hole centered over the chimney end (see figure 9).

	"X"
8-INCH PIPE SYSTEM	13-1/2"
10-INCH PIPE SYSTEM	17"
12-INCH PIPE SYSTEM	17"

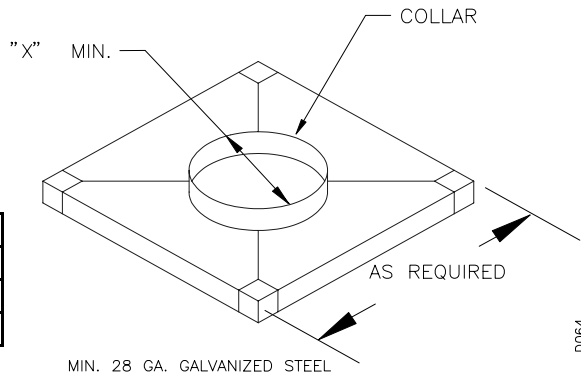

Figure 9 CHASE TOP FLASHING

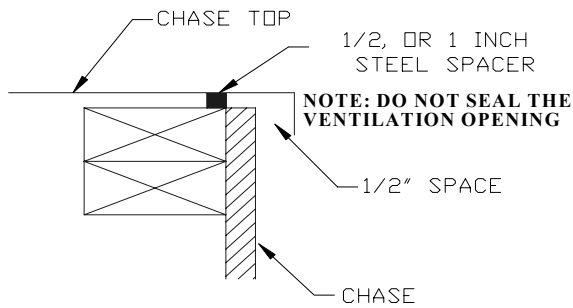

Figure 10 **1/2 OR 1 INCH CLEARANCE**

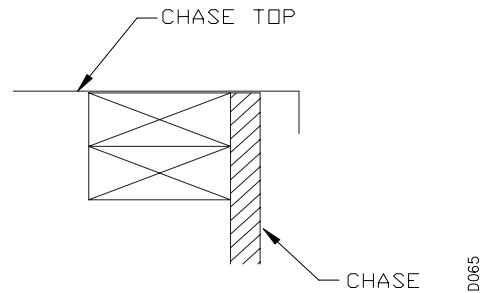

Figure 11 **ZERO CLEARANCE**

ZERO MINIMUM SPACER CLEARANCE

FABRICATED SHROUD REQUIRED

- STANDARD ARCH SHROUD
28L x 30W x 27.50H (see figure 1)
- BISHOPS ARCH SHROUD
28L x 30W x 27.50H (see figure 2)
- SQUARE SHROUD
26 x 26 x 15.75H (see figure 5)
with a 3-inch opening on all sides
- SQUARE SHROUD (TAPERED)
26 x 26 x 15.75H (see figure 6)
with a 3-inch opening on all sides

TERMINATION CAP MODEL REQUIRED

- RT-8DM, RTT-8DM
- RT-8DM, RTT-8DM
- RT-8DM, RTT-8DM
- RT-8DM, RTT-8DM

1/2" MINIMUM SPACER CLEARANCE

FABRICATED SHROUD REQUIRED

- SQUARE SHROUD
26 x 26 x 15.75H (see figure 5)
with a 3-inch opening on all sides
- SQUARE SHROUD (TAPERED)
26 x 26 x 15.75H (see figure 6)
with a 3-inch opening on all sides

TERMINATION CAP MODEL REQUIRED

- RTL-8DM, RTTL-8DM, RTL-10DM
- RTL-8DM, RTTL-8DM, RTL-10DM

1" MINIMUM SPACER CLEARANCE

FABRICATED SHROUD REQUIRED

- SQUARE SHROUD
32 x 32 x 15.75H (see figure 3)
with 1 and 3 inch openings on opposite sides
- SQUARE SHROUD (TAPERED)
32 x 32 x 15.75H (see figure 4)
with 1 and 3 inch openings on opposite sides
- STANDARD ARCH SHROUD
28L x 30W x 27.50H (see figure 1)
- BISHOPS ARCH SHROUD
28L x 30W x 27.50H (see figure 2)

TERMINATION CAP MODEL REQUIRED

- RT-8DM, RTT-8DM, RTL-8DM
RTTL-8DM, RTL-10DM, RTL-12D
- RT-8DM, RTT-8DM, RTL-8DM
RTTL-8DM, RTL-10DM, RTL-12D
- RTL-10DM, RTL-12D
- RTL-10DM, RTL-12D

INSTALLATION OF DESA FABRICATED SHROUD LEGS (MODEL SLK)

Place the chase flashing on top of the shroud leg tabs (bent) and secure with self-drilling screws as shown in figure 12.

NOTE: both corner edges should be flush. Repeat this procedure for each corner of the shroud.

The Shroud Leg Kit (SLK) contains 4 shroud legs and 24 self-drilling screws.

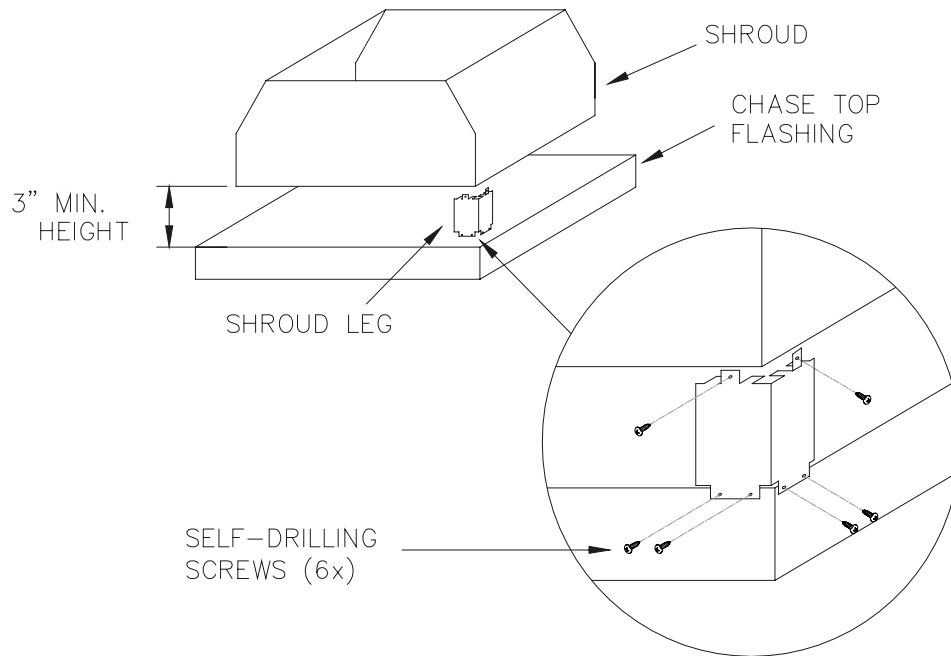

Figure 12

SHROUD LEG INSTALLATION

DESA fabricated shroud legs can be utilized to provide a 3" opening between the bottom of the shroud and the chase top flashing.